

# WSM

---

WORKSHOP MANUAL  
TRACTOR

M9540  
DUAL SPEED

---

**Kubota**

(Continued)

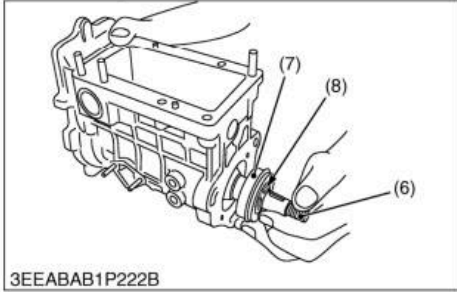

3EEABAB1P222B

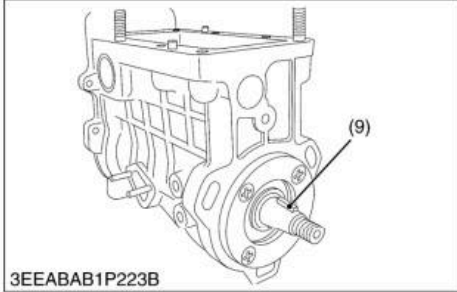

3EEABAB1P223B

**(When reassembling)**

- Fix the fuel camshaft with lock bolts as the key way of fuel camshaft (9) is upward.
- Install the injection pump assembly to the injection pump housing.
- Attach the O-ring and the cover and tighten the cover mounting bolts.
- Install the governor sleeve to the fuel camshaft.
- Check the movement of the governor sleeve.

**NOTE**

- **Be careful not to damage the O-ring.**
- **Be careful the direction of the governor sleeve.**
- **When reassembling the inside parts, put the oil on each inside part slightly.**

Tightening torque	Fuel camshaft stopper mounting screw	7.9 to 9.3 N·m 0.80 to 0.95 kgf·m 5.8 to 6.8 lbf·ft
	Governor weight mounting nut	63 to 72 N·m 6.4 to 7.4 kgf·m 47 to 53 lbf·ft

- |                             |                              |
|-----------------------------|------------------------------|
| (1) Governor Sleeve         | (6) Fuel Camshaft            |
| (2) Injection Pump Assembly | (7) Bearing                  |
| (3) Open End Wrench (22 mm) | (8) Cir-clip                 |
| (4) Governor Weight         | (9) Key Way of Fuel Camshaft |
| (5) Fuel Camshaft Stopper   |                              |

W1144178

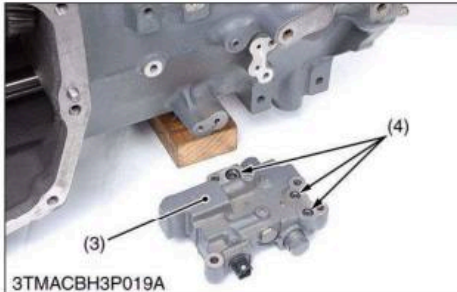
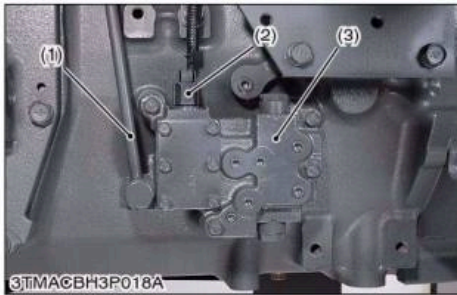
**(4) Dual Speed Solenoid Valve****Dial Speed Valve Solenoid Assembly**

1. Disconnect the harness coupler (2).
2. Remove the dual speed valve delivery pipe (1).
3. Remove the dual speed solenoid valve (3).

**(When reassembling)**

- Be sure to fix the O-rings (4) in position as shown photo and apply transmission fluid to the O-rings (4).

Tightening torque	Joint screw for hydraulic pipe	29.4 to 34.3 N·m 3.0 to 3.5 kgf·m 21.7 to 25.3 lbf·ft
-------------------	--------------------------------	---

- (1) Dual Speed Solenoid Valve Delivery Pipe      (3) Dual Speed Solenoid Valve  
(2) Coupler      (4) O-ring

W1019547

## 4. DISASSEMBLING AND ASSEMBLING

### [1] SEPARATING REAR AXLE

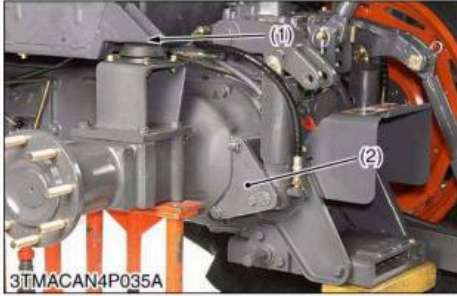

#### Removing Rear Axle Assembly

1. Remove the cylinder support (2).
2. Support the cabin and remove the cabin mounting bolt (1).
3. Remove the rear axle case mounting screws and nuts.
4. Support the rear axle case with nylon lift strap and hoist.
5. Separate the rear axle case from transmission case.

#### ■ IMPORTANT

- Be sure to support the rear axle and make sure the balance for support position.
- Hoist up and support the rear axle under neath as shown photo.

#### (When reassembling)

- Apply liquid gasket (Three Bond 1206C or equivalent) to joint face of the rear axle case and transmission case, after eliminate the water, oil and stuck liquid gasket.
- Be sure to assemble the cabin mount as shown figure.

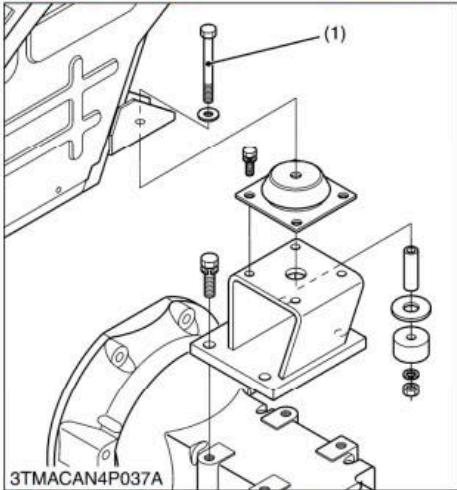

Tightening torque	Cabin mounting bolt and nut (M14, 7T)	124 to 147 N·m 12.6 to 15.0 kgf·m 91.2 to 108 lbf·ft
	Rear axle case mounting screw and nut	197 to 225 N·m 20.0 to 23.0 kgf·m 145 to 166 lbf·ft

(1) Cabin Mounting Bolt

(2) Cylinder Support

W1026233



# SERVICING

## CONTENTS

1. TROUBLESHOOTING .....	9-S1
2. SERVICING SPECIFICATIONS .....	9-S6
3. TIGHTENING TORQUES .....	9-S7
4. CHECKING AND ADJUSTING .....	9-S8
[1] BATTERY, FUSE, GROUNDING AND CONNECTOR.....	9-S8
(1) Battery.....	9-S8
(2) Checking Fuse .....	9-S11
(3) Checking Grounding Wires .....	9-S12
(4) Connector .....	9-S12
[2] MAIN SWITCH.....	9-S13
[3] AIR HEATER.....	9-S14
[4] STARTER MOTOR.....	9-S15
[5] ENGINE STOP SOLENOID.....	9-S16
[6] ALTERNATOR.....	9-S17
[7] METER PANEL.....	9-S18
(1) Setting Mode (Select the PTO Display Mode Switching, Tractor Model Select and Entering Travel Speed Coefficient) .....	9-S18
(2) Checking Mode .....	9-S22
(3) Checking Meter Panel, PTO/Hour Meter Select Switch and Traveling Speed Select Switch .....	9-S23
(4) Switch and Sensor .....	9-S25
[8] LIGHTING SWITCHES AND FLASHER UNIT.....	9-S32
(1) Lever Combination Switch and Horn Switch.....	9-S32
(2) Hazard Switch.....	9-S33
(3) Flasher Unit.....	9-S34
(4) Front/Rear Work Light and Beacon Light Switch .....	9-S35
[9] RELAYS .....	9-S36
(1) Starter Relay and Heater Relay .....	9-S36
(2) Relays .....	9-S37
(3) OPC (Operator Presence Control) System .....	9-S38
[10] SOLENOID VALVE .....	9-S39
(1) PTO, 4WD and Rear Differential Lock .....	9-S39
(2) Hi-Lo Dual Speed.....	9-S40
5. DISASSEMBLING AND ASSEMBLING .....	9-S41
[1] STARTER MOTOR.....	9-S41
[2] ALTERNATOR.....	9-S41
[3] FUSE (SLOW BLOW 100 A).....	9-S44
6. SERVICING .....	9-S45
[1] STARTER .....	9-S45
[2] ALTERNATOR.....	9-S47

# Full Version Available

Kubota M9540 Tractor Workshop Manual

This is a short preview. The complete manual contains all chapters, wiring diagrams, torque specifications and full service procedures.

**VIEW THE FULL MANUAL**

<https://machinecatalogic.com/kubota-m9540-tractor-workshop-manual/>