

WSM

WORKSHOP MANUAL
ROTARY MOWER

RC72-38

Kubota

3. LUBRICANTS

No.	Place	Capacity	Lubricants
1	Gear Box	0.36 L 0.38 U.S.qts. 0.32 Imp.qts.	SAE 90 gear oil (API Service GL-5 gear oil)
Greasing			
2	Universal joint	Until grease overflows	SAE multi-purpose type grease
3	Spindle shafts (Bevel gear shaft and blade shafts)		
4	Belt tension pulley		
5	Belt tension pivot		
6	Life arms		
7	Front gauge wheels		
8	Rear gauge wheel		
9	Front center anti-scalp roller		

[5] CHECK POINT OF EVERY 2 YEARS

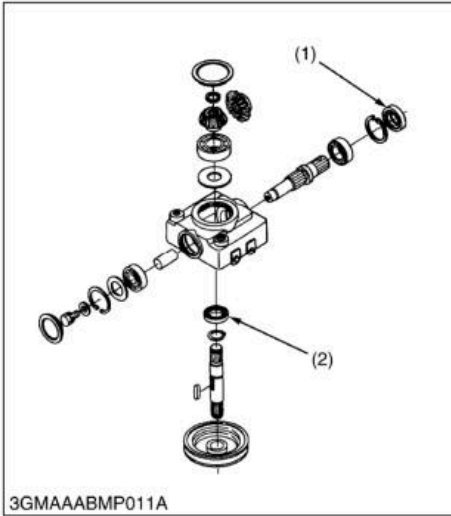

Replacing Gear Box Oil Seal

1. Replace the gear box oil seals (1), (2) with new ones. (See page S-7.)

(1) Oil Seal

(2) Oil Seal

W1029072

machinecatalogic.com

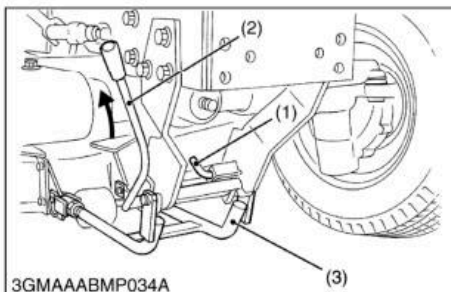
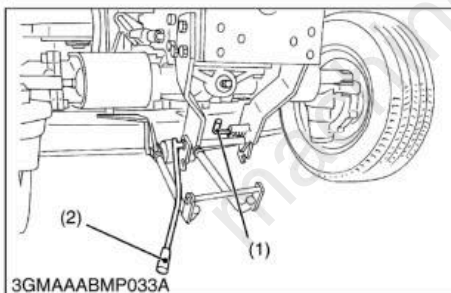
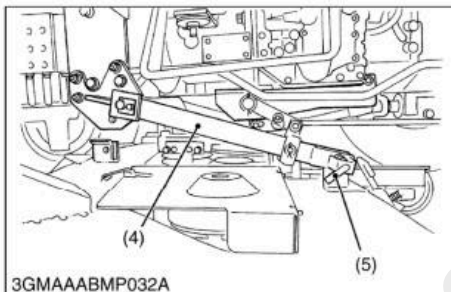
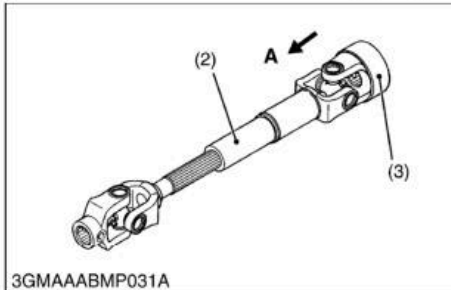
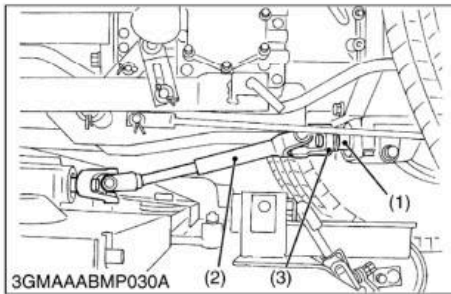

Mounting Universal Joint and Rear Link

1. Pull back the coupler (3) of the universal joint.
2. Push the universal joint (2) onto the mid-PTO shaft, and release the coupler (3).
3. Slide the universal joint back and forward to make sure the universal joint is locked securely.
4. Move the hydraulic (position) control lever forward to lower the mower rear links.
5. Attach the rear links (4) to the mower deck, pulling the L pins (5).

- | | |
|---------------------|----------------|
| (1) Mid PTO Shaft | (4) Rear Link |
| (2) Universal Joint | (5) L Pin |
| (3) Coupler | A : TUG |

W1030772

Mounting Front Link

1. Pull the front L pin and lock it. Then lower the front lever (2).
2. Hook the front link (3) to the lever fulcrum, and lift the front lever (2).
3. Release the L pin to lock the front lever (2).

■ NOTE

- Make sure the front lever (2) is fixed with L pin (1) securely.

- | | |
|-----------------|----------------|
| (1) L pin | (3) Front Link |
| (2) Front Lever | |

W1031053

4. CHECKING, DISASSEMBLING AND SERVICING

[1] CHECKING AND ADJUSTING

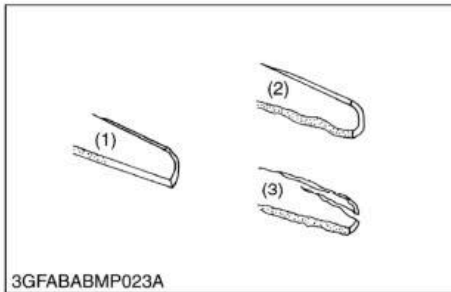

Checking Mower Blade

1. Check the cutting edge of mower blade.
2. Sharpen the cutting edges, if the mower blades are as shown in figure (2).
3. Replace the mower blades, if they are as shown in figure (3).

■ IMPORTANT

- Never forget to set the dust cover, two cup washers and spline boss, when reassembling the mower blades. (See page S-6.)

■ NOTE

- To sharpen the mower blades by yourself, clamp the mower blade securely in a vise and use a large mill file along the original bevel.
- To balance the mower blade, place a small rod through the center hole and check to see if the blade balance evenly. File heavy side of the blade until it balance out even.

- (1) New Blade
(2) Worn Blade

- (3) Cracked Blade

W1011041

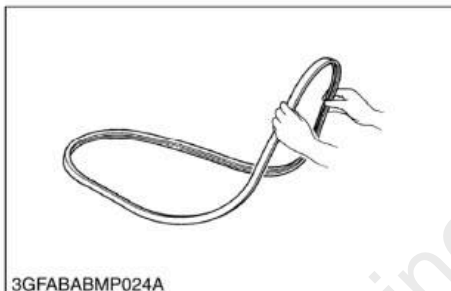

Checking Mower Belt

1. Check to see the mower belt.
2. Replace the mower belt with a new one, if there is found surface split at more than 3 positions.

(When replacing mower belt)

1. Dismount the mower from the tractor.
2. Remove the left and right hand belt cover from the mower deck.
3. Clean around the gear box.
4. Remove the right hand stay (3) which mounts the gear box to the mower deck.
5. Remove the mower belt (2) from the tension pulley (1). Slip the mower belt over the top of the gear box.
6. To install a new belt, reverse the above procedure.

Tightening torque	Gear box mounting screw (Standard type / Reamer type)	77.6 to 90.2 N·m 8.0 to 9.2 kgf·m 57.1 to 66.5 ft·lbs

- (1) Tension Pulley
(2) Mower Belt

- (3) Gear Box Stay (Right)
(4) Gear Box Stay (Left)

W1011180

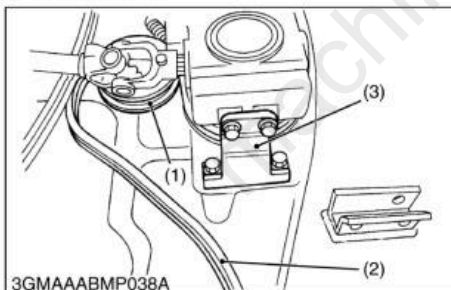

Full Version Available

Kubota RC72-38 Rotary Mower Workshop Manual

This is a short preview. The complete manual contains all chapters, wiring diagrams, torque specifications and full service procedures.

VIEW THE FULL MANUAL

<https://machinecatalogic.com/kubota-rc72-38-rotary-mower-workshop-manual/>