

# WSM

---

WORKSHOP MANUAL  
**TRACTOR, FRONT LOADER,  
BACKHOE, ROTARY MOWER**

**BX25, LA240, BT601, RCK54,  
RCK54P, RCK60B**

---

**Kubota**

## **2 TRANSAXLE**

machinecatalogic.com

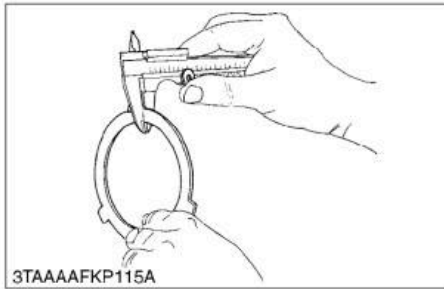

**Separate Plate and Back Plate Wear**

1. Measure the thickness of pressure plate and steel back with vernier calipers.
2. If the thickness is less than the allowable limit, replace it.

Thickness of separate plate	Factory spec.	0.9450 to 1.055 mm 0.03721 to 0.04153 in.
	Allowable limit	0.80 mm 0.031 in.

Thickness of back plate	Factory spec.	1.9 to 2.1 mm 0.075 to 0.082 in.
	Allowable limit	1.85 mm 0.0728 in.

W1017258

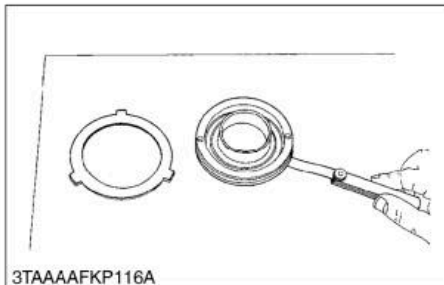

**Flatness of Clutch Piston, Pressure Plate and Steel Plate**

1. Place the part on a surface plate.
2. Check the flatness by inserting a feeler gauge (allowable limit size) underneath it at least four points.
3. If the gauge can be inserted, replace it.

Flatness of clutch piston	Allowable limit	0.15 mm 0.0059 in.
---------------------------	-----------------	-----------------------

Flatness of pressure plate and steel plate	Allowable limit	0.20 mm 0.0079 in.
--------------------------------------------	-----------------	-----------------------

W1017358

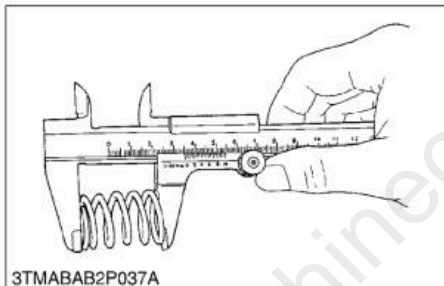

**Clutch Spring Free Length**

1. Measure the free length of spring with vernier calipers.
2. If the measurement is less than the allowable limit, replace it.

Clutch spring free length	Factory spec.	38.5 mm 1.52 in.
	Allowable limit	34.5 mm 1.36 in.

W1017533

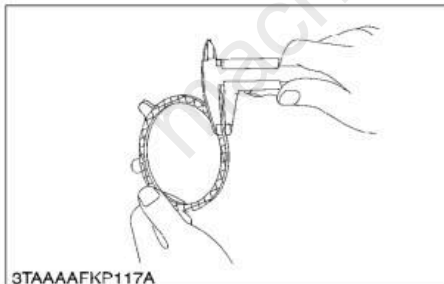

**PTO Brake Disc Wear**

1. Measure the PTO brake disc thickness with a vernier caliper.
2. If the thickness is less than allowable limit, replace it.

PTO brake disc thickness	Factory spec.	2.90 to 3.10 mm 0.115 to 0.122 in.
	Allowable limit	2.70 mm 0.11 in.

W1029590

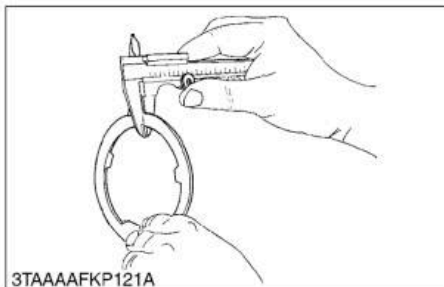

**PTO Brake Plate**

1. Measure the PTO brake plate thickness with a vernier caliper.
2. If the thickness is less than allowable limit, replace it.

PTO brake plate thickness	Factory spec.	1.9 to 2.1 mm 0.075 to 0.082 in.
	Allowable limit	1.85 mm 0.0728 in.

W1095464

## 2. HYDRAULIC PUMP

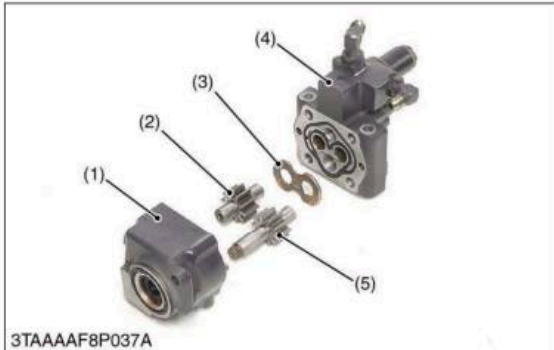

3TAAAAF8P037A

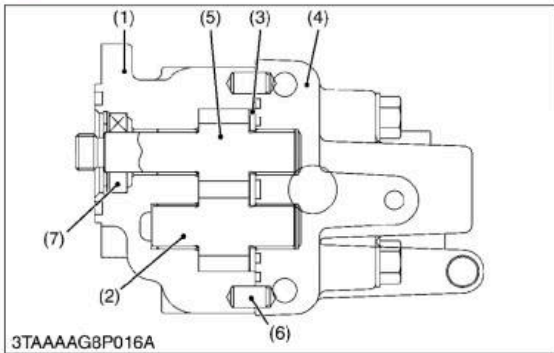

3TAAAAG8P016A

The hydraulic pump is composed of the casing (1), cover (4), side plate (3), and two spur gears (drive gear (5) and driven gear (2)) that are in mesh.

Hydraulic pump is driven by the pump drive shaft in the transmission case.

Maximum displacement is as follows.

Displacement	Engine speed	Condition
23.5 L/min. 6.2 U.S.gals./min. 5.2 Imp.gals./min.	At 3200 min <sup>-1</sup> (rpm)	at no load

- (1) Casing
- (2) Driven Gear
- (3) Side Plate
- (4) Cover
- (5) Drive Gear
- (6) Pin
- (7) Oil Seal

W1013860

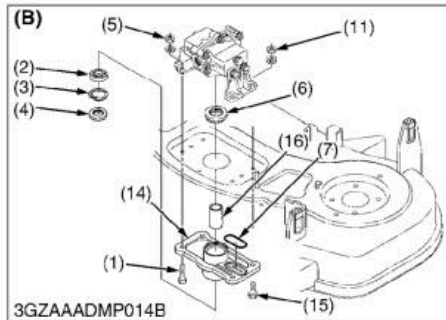
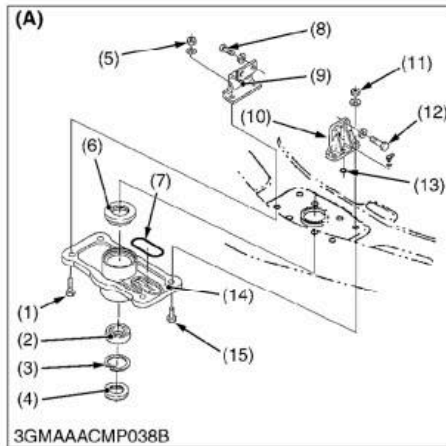

**Center Pulley Holder**

1. Unscrew the center pulley holder screws (1), (15) / center pulley nut (5), (11).
2. Remove the upper oil seal (6) and lower oil seal (4).
3. Remove the internal snap ring (3) and ball bearing (2).

**(When reassembling)**

- Replace the oil seals (4), (6) with new ones.
- Install the reamer screws (12) / reamer bolt (15) at their original positions as shown in the figure.
- Be sure to fix the O-rings (7), (13) to the original position.

**NOTE**

- **When reassembling the center pulley holder (14), gear box and gear box stays (9), (10), tighten the bolts and nuts in the order as below, to prevent the incline the gear box.**
- **Tighten the reamer bolts (12) to the gear box first, then tighten the reamer bolts (15) and nut (11) to the center pulley holder (14) with specified torque.**
- **Tighten the gear box screws (8) to the gear box, then tighten the center pulley holder bolts (1) and nut (5) with specified torque.**
- **See page S-22 for tightening torque of gear box screw.**

Tightening torque	Center pulley holder bolt and nut	77.4 to 90.2 N·m 7.9 to 9.2 kgf·m 57.1 to 66.5 ft·lbs
-------------------	-----------------------------------	-------------------------------------------------------------

- |                                                                                                                                                                                                                                                                                                    |                                                                                                                                                                                                                           |
|----------------------------------------------------------------------------------------------------------------------------------------------------------------------------------------------------------------------------------------------------------------------------------------------------|---------------------------------------------------------------------------------------------------------------------------------------------------------------------------------------------------------------------------|
| <ul style="list-style-type: none"> <li>(1) Center Pulley Holder bolt</li> <li>(2) Ball Bearing</li> <li>(3) Snap Ring</li> <li>(4) Oil Seal</li> <li>(5) Nut</li> <li>(6) Oil Seal</li> <li>(7) O-ring</li> <li>(8) O-ring</li> <li>(9) Gear Box Stay RH</li> <li>(10) Gear Box Stay LH</li> </ul> | <ul style="list-style-type: none"> <li>(11) Nut</li> <li>(12) Gear Box Reamer Bolt</li> <li>(13) O-ring</li> <li>(14) Center Pulley Holder</li> <li>(15) Center Pulley Holder Reamer Bolt</li> <li>(16) Collar</li> </ul> |
|----------------------------------------------------------------------------------------------------------------------------------------------------------------------------------------------------------------------------------------------------------------------------------------------------|---------------------------------------------------------------------------------------------------------------------------------------------------------------------------------------------------------------------------|

**(A) RCK54-23BX, RCK60B-23BX**  
**(B) RCK54P-23BX**

W1013720

# Full Version Available

Kubota RCK54P Rotary Mower Workshop Manual

This is a short preview. The complete manual contains all chapters, wiring diagrams, torque specifications and full service procedures.

**VIEW THE FULL MANUAL**

<https://machinecatalogic.com/kubota-rck54p-rotary-mower-workshop-manual/>